

ISOMETRIC VIEW

ITEM NO.	DESCRIPTION	QTY
1	BRACKET WITH PIN STRIKER	1
2	TAP PLATE, STRIKER PIN BRACKET	1
3	SCREW W/ LOCKING PATCH, 1/4-20 X 3/4" BUTTON HEAD	2
4	FENDER WASHER, 17/64" ID X 7/8" OD X 1/16"	2

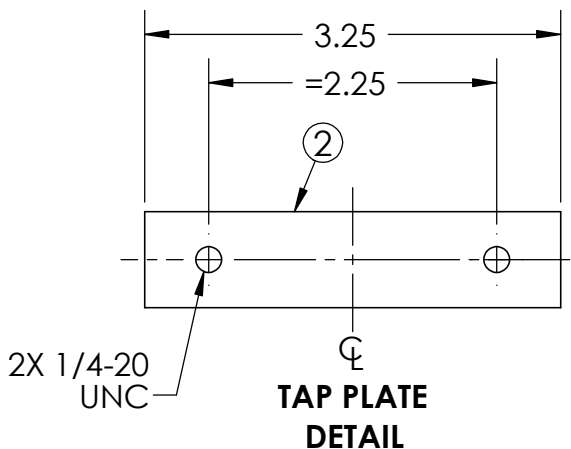

TAP PLATE
DETAIL

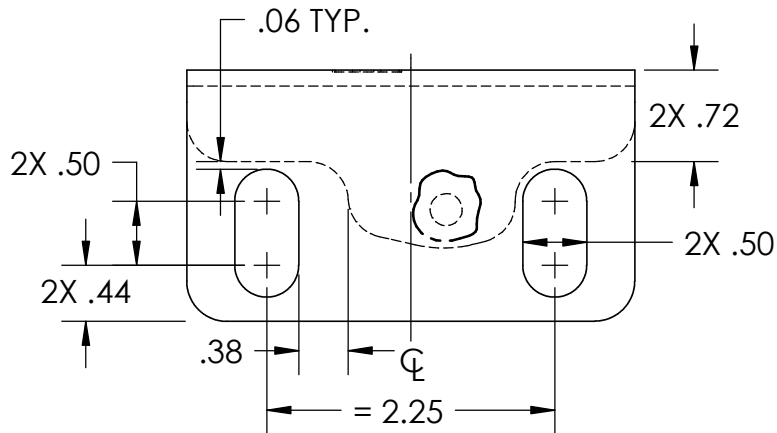
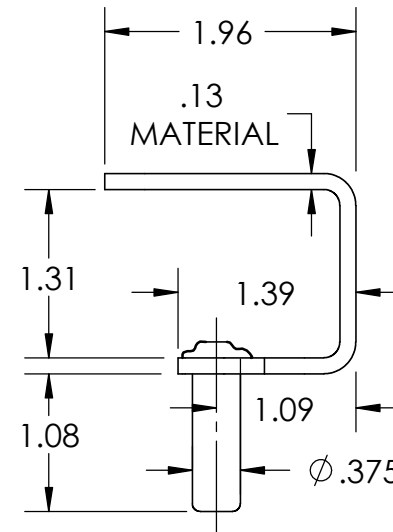
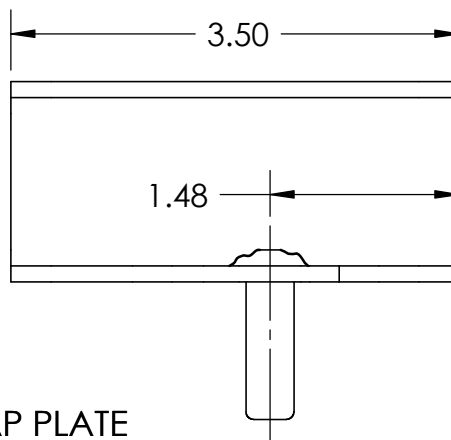
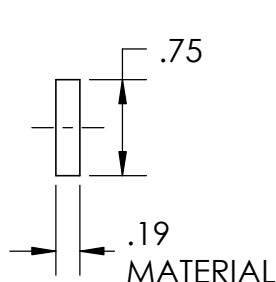

NOTES:

1. MATERIALS AND FINISHES: WELDED STRIKER PIN, TAP PLATE AND BRACKET TO BE OF 1018 COLD ROLLED STEEL. ALL COMPONENTS TO BE CLEAR ZINC PLATED
2. LOCKING PATCH ON SCREWS MUST ENGAGE THREADS ON TAP PLATE WHEN TAP PLATE AND STRIKER BRACKET ARE SANDWICHED ON .06 - .09 THICK BODY PANEL MATERIAL
3. = DENOTES DIMENSIONS EQUALLY SPACED ABOUT PART CENTERLINE
4. ALL DIMENSIONS ARE FOR REFERENCE ONLY

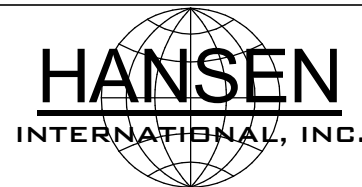

DESCRIPTION:	ASSY, PIN STRIKER	Weight	0.61 LBS
Part Number:	AISTUA01	REV	-
<small>PROPRIETARY NOTICE: THIS DRAWING IS EXCLUSIVELY THE PROPERTY OF HANSEN INTERNATIONAL INC. AND SHALL NOT BE COPIED OR PASSED ON TO A THIRD PARTY WITHOUT OUR PRIOR WRITTEN APPROVAL. WE WILL RETAIN ALL RIGHTS FOR PATENT ISSUE OR REGISTRATION OF DESIGN. ©2019 Hansen International, Inc.</small>			