

**NOTES:**

1. MATERIAL AND FINISH: POLISHED STAINLESS STEEL TRAY AND HANDLE. ALL OTHER COMPONENTS ARE STAINLESS STEEL OR ZINC PLATED STEEL.
2. = DENOTES DIMENSIONS THAT EQUALLY SPACED ABOUT THE CENTERLINE.
3. NYLOCK NUTS RECOMMENDED FOR INSTALL. TORQUE TO 17 IN/LBS.
4. DIMENSIONS ARE FOR REFERENCE ONLY.

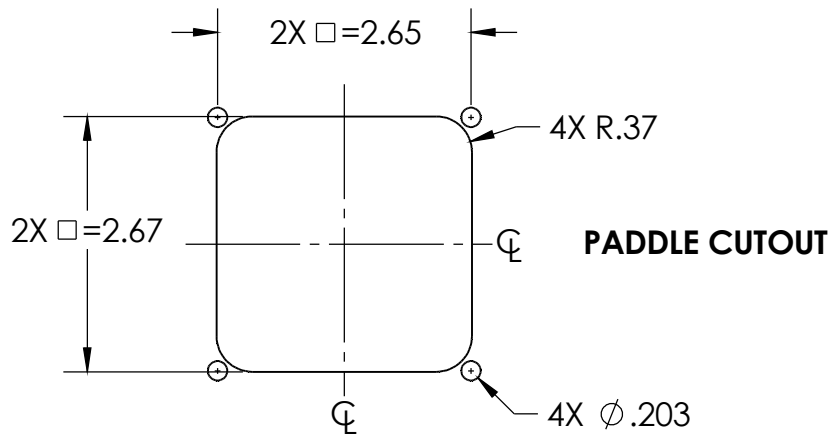
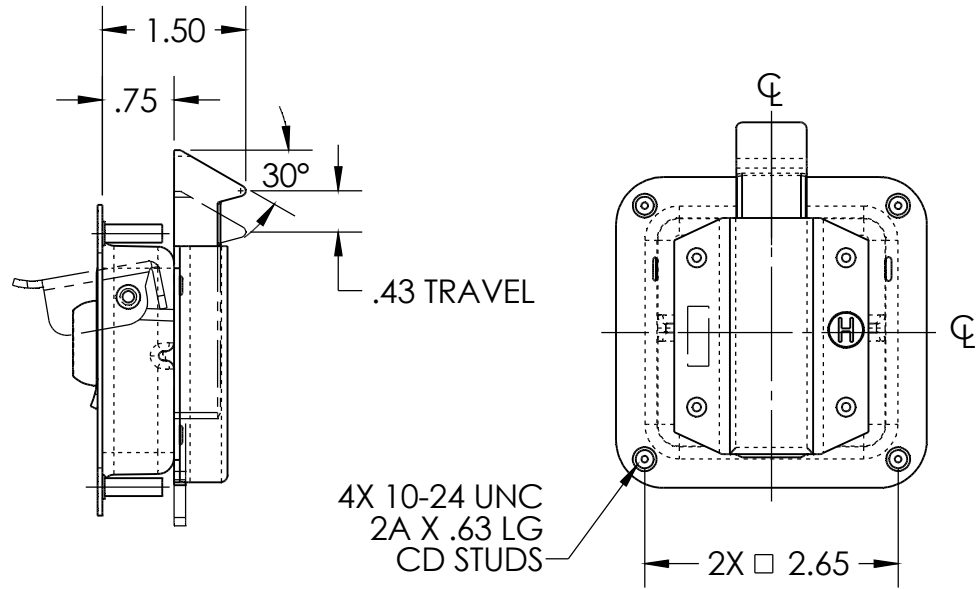
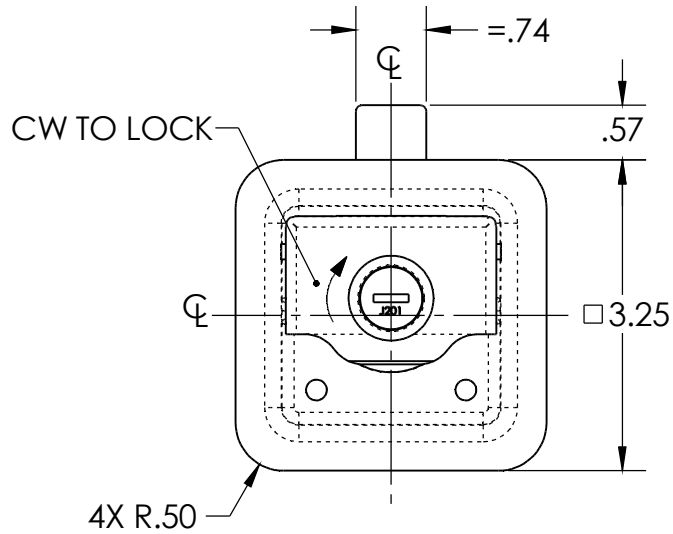

DESCRIPTION: ASM. SQ. MINI- SPECIAL LOCKING W/STUDS	Weight .75 LBS
Part Number: X9X88373XH-AL	REV -

PROPRIETARY NOTICE: THIS DRAWING IS EXCLUSIVELY THE PROPERTY OF HANSEN INTERNATIONAL INC. AND SHALL NOT BE COPIED OR PASSED ON TO A THIRD PARTY WITHOUT OUR PRIOR WRITTEN APPROVAL. WE WILL RETAIN ALL RIGHTS FOR PATENT ISSUE OR REGISTRATION OF DESIGN.  
©2018 Hansen International, Inc.